



For round sight glass fittings according to DIN 28120 in the nominal sizes DN 100 | DN 125 | DN 150 | DN 200

USAGE

The sight glass wipers of type SW2 have been specifically developed for the manual, as-needed cleaning of glass plates in round sight glass fittings according to DIN 28120. They enable effective removal of residues, adherences, or process residues on the inner side of the glass plate – completely without disassembly of the fitting. This ensures a permanently clear view of the process and supports visual process control even during ongoing operations. The wiper is designed for use under pressure conditions and is suitable for various industrial applications – from chemical process engineering to the pharmaceutical industry to general plant engineering. The robust construction from corrosion-resistant stainless steel guarantees a long service life, even with intensive use. Various materials are available for the wiper blade, which can be selected depending on the medium, temperature range, or sensitivity of the glass surface. The SW2 is compatible with round sight glass fittings in nominal sizes DN 100 to DN 200 and can be installed and operated easily.

INSTALLATION NOTE

With pressure-tight screwed connection through the base and cover flange of the sight glass fitting; suitable for round sight glass plates according to DIN 7080 or DIN 8902. Compatible with round sight glass fittings according to DIN 28120 in the nominal sizes DN 100 to DN 200.

DRAWING

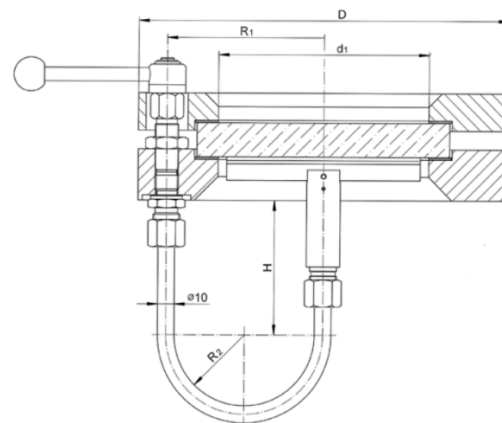

Operating condition

Temperature:	200 °C (depending on the flow sight glass plate used)
Pressure:	max. 16 barg

MEASUREMENTS

Dimensions					
Size		1	2	3	4
Nominal size	DN	100	125	150	200
Free view	d1	125	150	175	225
Flange	D	220	250	285	340
Wiper	R1	93	105	120	147.5
	R2	41.5	47.5	55	68.75
	H	79	69.5	85	63.5

PARTS AND MATERIALS - TABLE

Parts and materials		
1.	Locking washer	1.4568
2.	Spacer	A2
3.	Ball knob	Duroplast (brass socket)
4.	Handle rod	1.4305
5.	Spacer piece	1.4305
6.	Hexagon nut	A4
7.	Threaded socket	1.4301
8.	Seal disk	PTFE
9.	Pipe union	1.4571
10.	Union nut	1.4571
11.	Flexible shaft	1.4310 or 1.4401
12.	Slip bearing	Steel
13.	Adjustment ring	1.4305
14.	Shaft connection	1.4305
15.	Washer	Galvanized steel
16.	Wedge ring	1.4571
17.	Wiper blade holder	1.4571
18.	Wiper blade	Silicone or PTFE
19.	Notched pin	1.4571
20.	Wiper arm shaft	1.4571 or 1.4401
21.	Compression spring	1.4310
22.	Wiper arm	1.4571 or 1.4401
23.	Guide bushing	1.4571 or 1.4401
24.	Wedge ring	1.4571
24.	Union nut	1.4571
26.	Guide tube	1.4571

