

Execution similar to DIN 11851 / EN 10357



## USAGE

Screwed sight glass fittings are used to observe processes inside boilers, containers, and pipelines. They are applied in the food sector, dairies, breweries, beverage industries, and in pharmaceutical and medical technology. Due to the screw cap, a quick cleaning of the sight glass is possible. The high permissible temperatures also allow for sterilization.

## INSTALLATION NOTE

The Welding ends of the threaded socket must be done without distortion to ensure optimal sealing and fit accuracy. All welding work may only be carried out by trained and appropriately authorized personnel.

## DRAWING

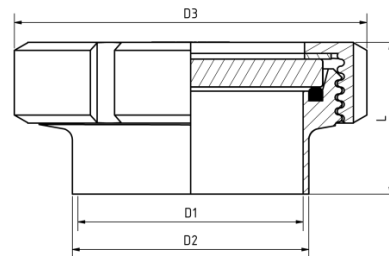

### Operating condition

Temperature: (depending on glass and gasket)	≤ 200 °C	Borosilicate glass DIN 7080 or similar
Pressure:	≤ 10 barg	
Pressure with wiper SGW:	≤ 6 barg	

Materials	
Stutzen / Slotted nut:	1.4404; 1.4301/1.4306/1.4307
Glass:	Borosilicate glass DIN 7080 or similar
Seal:	PTFE; FKM; NBR; silicone; EPDM

DN	25	32	40	50	65	80	100	125	150
D1 [mm]	26	32	38	50	66	81	100	125	150
D2 [mm]	29	35	41	53	70	85	104	129	154
D3 [mm]	63	70	78	92	112	127	148	178	210
L [mm]	37	40	41	43	48	54	64	58	60
Weight [kg]	0.31	0.40	0.50	0.70	1.10	1.61	2.27	3.10	5.30
Surface Inside Ra ≤ 0.8 μm									

## PRODUCT CODE

Example for Explaining the Code Composition

**11 - 327 - 100 - 1 - 1 - 1 - 000**

GROUP	TYPE	NOMINAL SIZE	SOCKET/FLANGE NUT <sup>1</sup>	GLASS	GASKET	VARIANT
11	327	DN25	1) 1.4404	1) Borosilicate glass according to DIN 7080 or similar	1) PTFE	000) Standard
		DN 32	2) 1.4301/6/7	3) Borosilicate glass <sup>2</sup> + PTFE wiper SGW	2) FKM	
		DN 40		5) Borosilicate glass <sup>2</sup> + silicone wiper SGW	3) NBR	
		DN 50			5) Silicone	
		DN 65			6) EPDM	
		DN 80			8) Special	
		DN 100				
		DN 125				
		150				

1) Nutmutter according to offer / order confirmation

2) Similat to DIN 7080

Unless otherwise specified, the highlighted factory standard will be delivered.



## EXAMPLE

The product code **11-327-100-1-1-1-000** corresponds to the standard version:

ACI Type 327

DN 100

PN 10

Threaded socket made of 1.4404

Slotted nut made of 1.4404

Borosilicate glass DIN 7080

Gasket PTFE

## STRUCTURE

1. Slotted nut
2. Glass cushion
3. Sight glass
4. D-Ring gasket
5. Threaded socket

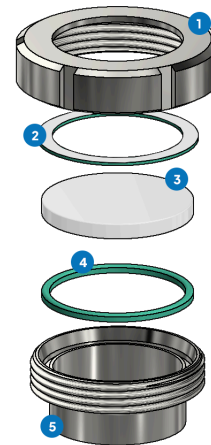

## QUICK OVERVIEW



max. 10 barg



heat resistant up to 200 °C



for liquid media



for gaseous media



Nominal sizes  
DN 25 - 150



Custom designs available



Accessories available

## OPERATING CONDITIONS

Operating conditions depend on the choice of glass and seals:

		SIGHT GLASS			GASKET		
		Borosilicate glass DIN 7080 or similar	PTFE max. 200 °C	FKM max. 200 °C	NBR max. 80 °C	Silicone max. 180 °C	EPDM max. 130 °C
TEMPERATURE	up to 80 °C	✔	✔	✔	✔	✔	✔
	up to 130 °C	✔	✔	✔	✘	✔	✔
	up to 180 °C	✔	✔	✔	✘	✔	✘
	up to 200 °C	✔	✔	✔	✘	✘	✘
PRESSURE	6 to 10 barg	✔	✔	✔	✔	✔	✔

✔ suitable    ✘ unsuitable

**OPTIONAL ACCESSORIES**



**Sight glass wiper**

- > with PTFE, silicone, EPDM or FKM wipers



**LED lamp in combination with wiper  
SGW**

- > for non-Ex areas



**LED lamp with flange attachment**

- > for Ex and non-Ex areas