

With internal thread connections according to DIN EN ISO 228-1

## USAGE

Flow sight glasses are used for monitoring levels and flows in pipelines. They enable reliable 360° monitoring of the function and performance of individual devices as well as complete systems. The flow sight glass type 622 is designed with internal threads on both sides according to DIN EN ISO 228-1.

## INSTALLATION NOTE

The screw connection must be sealed with a suitable sealing material to achieve the specified maximum working pressure. The connection thread is not self-sealing! Tubular sight glasses must be installed in such a way that no pipe forces (tension, pressure, torsion), vibrations, or shock pressures act on the fitting!

## DRAWING

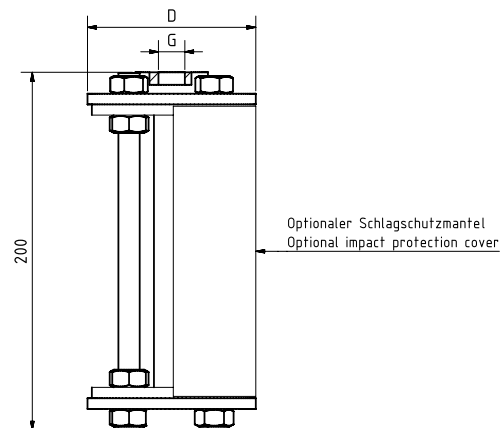

Type 622 with impact protection cover made of perforated sheet (VA)

Type 622 with impact protection cover made of plastic (PETg)

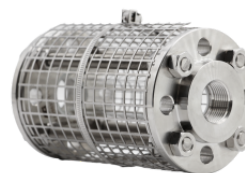

### Operating conditions

Temperature: (depending on glass and gasket)	up to 300 °C with borosilicate glass 3.3
Pressure:	≤ 16 barg

### Materials

Flange:	1.4571
Gasket <sup>2)</sup> :	PTFE; FKM; NBR; C4400; Silicone; EPDM; Graphite
Threaded rods / Nuts:	A4-70
Special materials on request	

2) See INFO Gaskets

## SPECIAL VERSIONS/OPTIONS

- a) Impact protection
- b) Special total length
- c) Additional options on request

**G THREAD**

NPS	3/8"	1/2"	3/4"	1"	1 1/2"	2"
D [mm]	95	95	105	115	150	175
Weight [kg]	2.3	2.3	2.9	3.5	6.2	8.2
PS [barg]	16	16	16	16	16	16
Other sizes, lengths and flange standards on request						



Observe the permissible operating pressure!

## PRODUCT CODE

Example for Explaining the Code Composition

**11 - 622 - 2 - 2 - 4 - 0 - 000**

GROUP	TYPE	THREAD	FLANGE	GASKET	SHOCK PROTECTION COVER	TOTAL LENGTH
11	622	1) 3/8"	2) 1.4571	18) PTFE (novaflon® 500)	0) without impact protection	000) Standard (200 mm)
		2) 1/2"	3) Special	2) FKM	1) with impact protection made of PETg (Tmax. 80 °C)	
		3) 3/4"		3) NBR	2) with impact protection made of perforated sheet (Tmax. 300 °C)	
		5) 1"		4) C4400		
		6) 1 1/2"		5) Silicone		
		7) 2"		6) EPDM		
		8) Special		7) Graphite		
				8) Special		



Unless otherwise specified, the highlighted factory standard will be delivered.

## EXAMPLE

The product code **11-622-2-2-4-1-000**  
corresponds to the standard version:

ACI type 622

BSP thread G 1/2"

PS max. 16 barg

Flanges made of 1.4571

Gasket KlingerSil® C4400

without impact protection

Total length 200 mm

## STRUCTURE

1. Nuts
2. Flange
3. Threaded rod
4. Borosilicate glass cylinder
5. Gasket

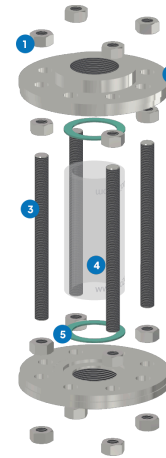

## QUICK OVERVIEW



max. 16 barg



heat-resistant up to 300 °C



for liquid media



for gaseous media



Nominal sizes 3/8" - 2"



Custom designs possible



> 50 sealing materials



Accessories available

## OPERATING CONDITIONS

Operating conditions depend on the choice of the glass and the seals:

		Sight glass				Gaskets			
		Borosilicate glass 3.3	PTFE max. 200 °C	FKM max. 200 °C	NBR max. 80 °C	C4400 max. 175 °C	Silicone max. 180 °C	EPDM max. 130 °C	Graphite > 300 °C
TEMPERATURE	up to 80 °C	✓	✓	✓	✓	✓	✓	✓	✓
	up to 130 °C	✓	✓	✓	✗	✓	✓	✓	✓
	up to 175 °C	✓	✓	✓	✗	✓	✓	✗	✓
	up to 200 °C	✓	✓	✓	✗	✗	✗	✗	✓
	up to 300 °C	✓	✗	✗	✗	✗	✗	✗	✓
PRESSURE	>300 °C	on request		on request					
	up to 16 barg	✓	✓	✓	✓	✓	✓	✓	✓

✓ suitable ✗ unsuitable

ACI Industriearmaturen GmbH

✉ info@aci24.com

☎ +49 (0) 2461 91634 00

🌐 www.aci24.com

📠 +49 (0) 2461 91634 44

📍 Königskamp 19 · 52428 Jülich · Germany